

COLORIZING BRASS STAMPINGS WITH PEARLEX POWDERS AND NUNN DESIGN RESIN
BY STEPHANIE GARD BUSS



1

Pour equal parts of A, then B, of Nunn Design 2-Part Resin into cup, mix for 2 minutes and put under lamp for 5 min.



2

Pour some resin onto a paper plate. Scoop a bit of the Pearl Ex Powders onto a craft stick, and mix it completely into the clear resin.

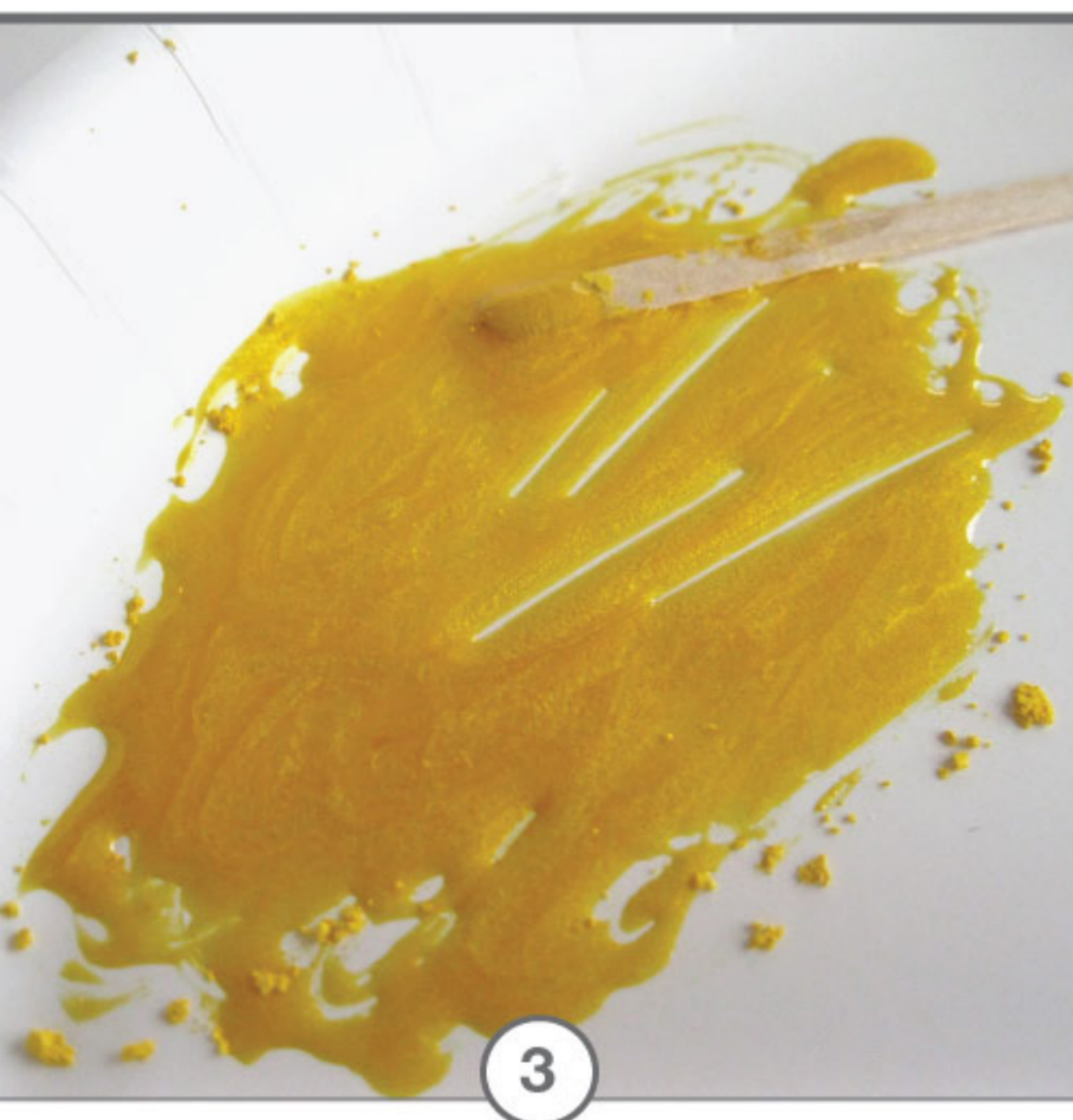

3

Here is some yellow Pearl Ex Powder mixed completely.



4

Once you have the Pearl Ex Powder mixed completely into the resin, you will want to let the resin thicken up a bit before using.



5

Cleaning with a wetwipe or gently sanding will allow the resin to attach to the surface when applied.



6

Once your resin has thickened, apply the resin onto a clean stir stick and slowly drizzle the resin onto the bee's body.

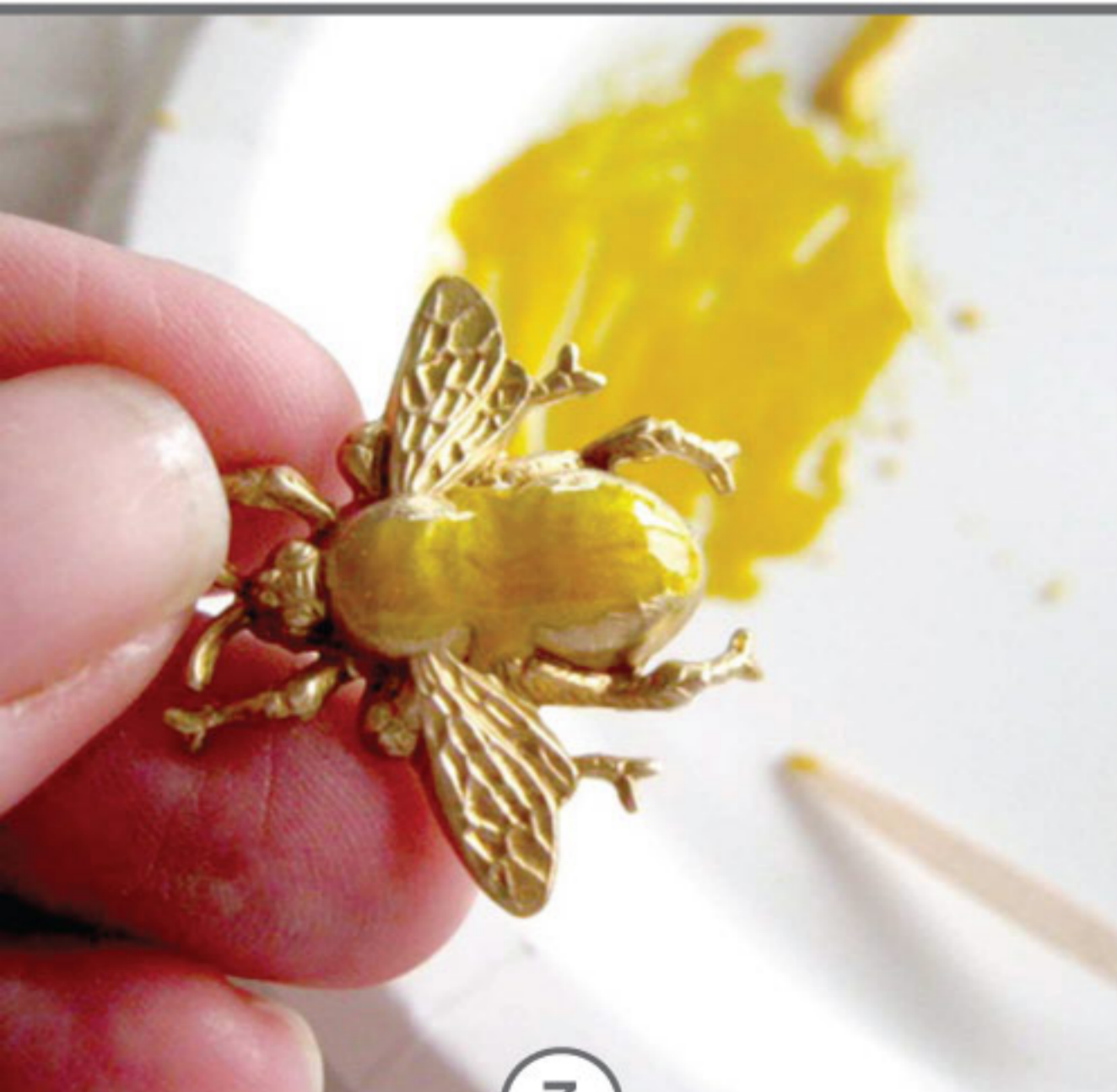

7

If the resin is too runny, just wipe it off with a baby wipe and wait a little while longer for the resin to thicken up and try again.



8

Once the resin is applied on the body and on the wings, set the bee aside to cure. The curing process can take up to 12 hours.



9

Using a strong metal glue (GS Hypo Cement), apply a generous amount to the back of the cured bee and attach to your piece, let dry.



10

There you have it. Now you can make a swarm of bees to adorn your jewelry!