



NUNN DESIGN®

How to Instructions for Resin "Make This" Charm Bracelet



We look forward to bringing you exclusive innovations
and distinctive products this year and beyond.

www.nunndesign.com

NUNN DESIGN SUPPLIES:

- 1 Gel du Soleil 4oz
- 2 Ornate Mini Pendant Rectangle - Antique Silver (ompr-sb)
- 1 Ornate Mini Pendant Square - Antique Silver (omps-sb)
- 1 Ornate Large Pendant Circle - Antique Silver (olpcs-sb)
- 1 Small Pendant Circle - Antique Silver (spc-sb)
- 1 Mini Link Single Loop Circle - Antique Silver (mlcs-sb)
- 1 Round toggle - Antique Silver (rt-sb)
- 1 Twig Toggle Bar - Antique Silver (ttb-sb)
- 12 Jumping 9mm Textured Oval - Antique Silver (jr9to-sb)
- 1 Small Heart Charm - Antique Silver (shso-b)
- 1 Key Charm - Antique Silver (kcs-b)
- 1 Elongated Heart Charm - Antique Silver (ehcs-b)
- 1 Collage Sheet Paris (csp)*
- 1 Nunn Design Glue 2oz (glue 2oz)

TOOLS NEEDED:

- Paintbrush
- Cotton Swab
- Headpin
- Matches
- Small Glass Dish
- Direct Sunlight or UV lamp
- Water (for rinsing brush)
- 2 pair needle-nose pliers (for opening/closing jumpings)
- 1 pair of cutters (to remove loop from mini link circle)
- Bond 527 or E6000 glue

*Collage Sheet image Note: Images used for this technique should be printed on text weight paper stock using a laser printer or at a reputable copy center.

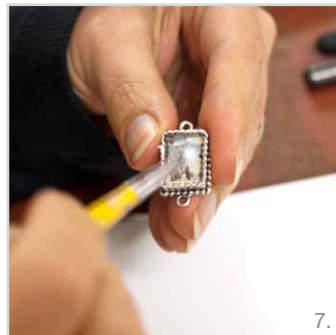

TO ASSEMBLE THE PENDANTS

STEP 1: (Images 1-3)

Select your image from the Paris Collage Sheet. Trim the image to fit the bezel of choice. (Leave the Small Link Circle – Antique Silver empty)

STEP 2: (Image 4-7)

Using the Nunn Design Glue, paint a thin coat into the base of the bezel. Place your collage image from Step 1 into the base of the bezel on the wet glue. Starting in the center, burnish the image down with a cotton swab, pressing any excess glue out to the edges

STEP 3: (Image 7)

Paint a thin coat of the Nunn Design Glue over the top of the collage image ensuring you cover all 90° angles.

STEP 4: (no image)

Let dry overnight (8 – 12 hours). *Note: The dry time is critical to prevent bubbles from occurring due to the moisture in the collage image.*

STEP 5: (Image 8)

Using the Gel du Soleil, drop a few drops into the center of your fully dried collage image. Tip the bezel slightly allowing the Gel to flow to the sides. Continue to add additional amounts of Gel until you have filled the bezel to the desired height.

STEP 6: (Image 9)

Use the headpin, matches, or a lighter to pop any bubbles that come to the surface. The headpin can be used directly on the bubble. To use the matches or lighter, hover the flame closely over the bubble in the resin – this will pull the bubble to the top and pop it. Be careful to keep the flame from actually touching the resin.

STEP 7: (Image 10)

Let cure for 20 minutes under a glass dish on the windowsill in direct sunlight or under a UV lamp. It must have the full intensity of the sun (no clouds) to cure.

TO ASSEMBLE THE BRACELET

STEP 8: (Images 11-13)

Using your cutters, cut the loop off of the end of the Mini Link Circle. Glue the piece into the center of the Small Link Circle using strong glue such as Bond 527 Cement or E6000.

STEP 9: (Image 14)

Using the 9mm Oval Jump rings, start to assemble the pieces using two pairs of needle-nose pliers to open and close the jump rings. Attach each bezel with a jump ring to the bracelet.