

How to Make an Itsy Bottle Boho Necklace

Designer: Becky Nunn

NUNN DESIGN SUPPLIES:

- 1 Itsy Bottle & Top Channel-Antique Gold (ibtc-gb)
- 1 gram of Crystal Clay Black
- 1' Deerskin Lace 5mm Chocolate (dsl5c-b)
- 16" Faceted Bead Chain-Antique Gold (fbc-gb)
- 1' 26 gauge gold wire
- 2 Ball Chain Crimp Connectors-Antique Gold (bccc-gb)
- 1 Lobster Clasp 15mm-Antique Gold (lc15-gb)
- 6 Jumpring 6mm Textured Circle-Antique Gold (jr6tc-gb)
- 4 Jumpring 9mm Textured Circle-Antique Gold (jr9tc-gb)
- 1 Jumpring Grande Rope-Antique Gold (jrgr-gb)
- 1 Charm Tree of Life-Antique Gold (ctol-gb)
- 1 Charm Itsy Circle Heart-Antique Gold (cich-gb)
- 1 Charm Buddha-Antique Gold (cb-gb)
- 1 Hammered Flat Tag Long Narrow Single Hole-Antique Gold (hftlins-gb)



TOOLS NEEDED:

- 1 pair of Shear Flush Cutters
- 2 pair of Needle Nose Pliers

OTHER SUPPLIES:

- Multi Purpose Adhesive such as Bond 527 Cement or E6000
- Small cello bag or other plastic bag
- Toothpick or Headpin
- Wet-wipes

LEARN MORE:

Visit the blog post for this tutorial:
[Itsy Bottle Boho Necklace Tutorial + Kit](#)



1.



2.



3.

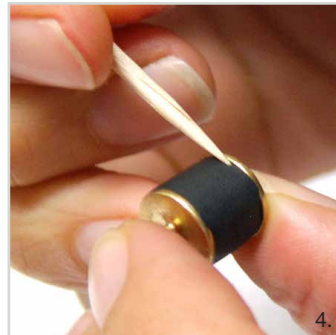

4.



5.

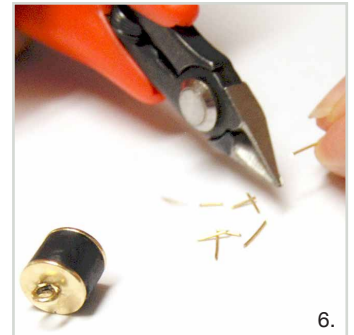

6.

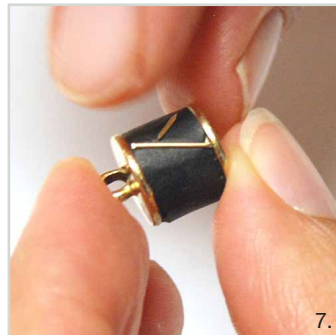

7.



8.



9.

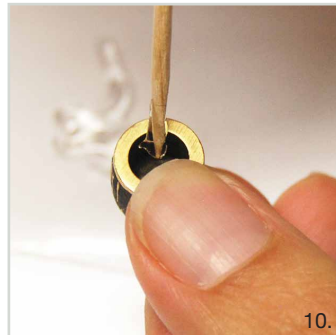

10.

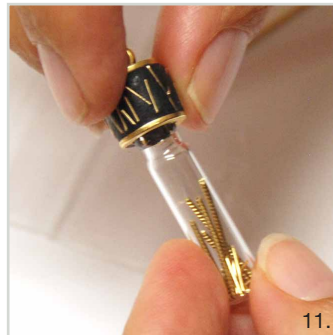

11.



12.



13.



14.

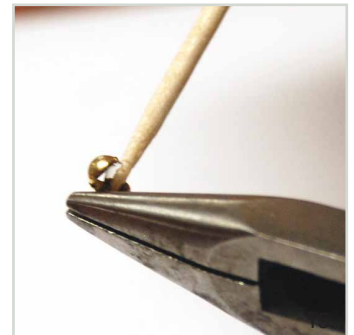

How to Make an Itsy Bottle Boho Necklace

Designer: Becky Nunn



CREATING THE ITSY BOTTLE TOP

STEP 1:

Crystal Clay is two-part epoxy clay that cures in 90-120 minutes. When handling the unmixed Crystal Clay, it is best to wear gloves. Mix together the two balls of Part A and Part B and blend together fully until the clay is no longer marbled and becomes uniform in color. You have approximately 90-120 minutes of working time once Part A and B has been blended before the clay starts to harden, so take your time. Once the clay is thoroughly mixed, remove your gloves to make it easier to work with the clay.

TIP: If the Crystal Clay is too hard to blend together, place the clay back into an airtight bag and place in hot tap water for 5 minutes. This will soften the clay and make it easy to blend together.

STEP 2: (Images 1-2)

Roll the thoroughly mixed Epoxy Clay-Crystal Clay between your palms until it forms a smooth round ball. Once your ball is smooth and round, roll the clay into a rope-like shape approximately 1 - 1 1/2" in length.

STEP 3: (Images 3-4)

Gently lay the rope shape of Crystal Clay into the Itsy Channel Bottle Top starting at one end. Apply enough of the clay to cover the base, but not so much that it is overflowing the sides. I use my thumb to push the clay forward into the channel while pulling the clay with my other hand. This will feel clumsy at first, but just keep going. The goal is to get a thin layer of clay into the base of the channel. If you have excess clay once you have wrapped the clay all away around, pinch off the excess and pat together the seam with your fingertips. Use a headpin or toothpick to scrape away any excess clay that might have squeezed up along the sides.

STEP 4: (Image 5)

Using a wet-wipe, clean up any excess Crystal Clay that might have been left on the Itsy Channel Bottle Top. The Crystal Clay hardens like cement, so cleaning it up now and being tidy as you go makes the process easier and the results so much nicer.

How to Make an Itsy Bottle Boho Necklace

Designer: Becky Nunn



STEP 5: (Images 6-8)

Using a pair of Flush Cutters cut a variety of lengths of 26 gauge gold wire. The maximum length should be not greater than 1/4". Gently place the cut wire in a random pattern into the top of the Itsy Bottle Channel that is filled with the uncured clay. After you have a design that you are happy with, use your fingers to gently embed the wire deeper into the clay. If you don't like the design you have created, remove the wire and try again until you are in love with your creation.

STEP 6: (Images 9-11)

Let the Crystal Clay cure for 24 hours. Once the Itsy Bottle Top is cured, fill the bottle with whatever you desire. Squeeze a wee bit of Bond 527 Cement (or E6000) onto a small plastic bag. Using a toothpick, insert a wee bit of glue into the inside top of the Itsy Bottle's lid. Press it closed and let dry with the bottle standing up.

CREATING THE BOHO NECKLACE

STEP 7: (Images 12-13)

On each of the ends of the 5mm Chocolate Deerskin Lace, fold 1" of the leather over on itself - creating a 'loop' on one end.

Create a 90-degree angle on the end of the 26-gauge wire. Place the 26-gauge wire down onto the backside of the folded loop leather end. Wrap the wire around the leather 3 times, wrapping over the starting point to secure the wire to the leather.

You should now have a 9" piece of Deerskin Lace with loops on both ends.

STEP 8: (Image 14)

Using 2 pair of needle nose pliers, open 2 of the Jumping 9mm Textured Circle and attach one on each end of the Deerskin Lace. On one of the ends of the Deerskin Lace, attach a 6mm Textured Circle and a Charm Buddha.

STEP 9: (Images 15-16)

When adding the Ball Chain Crimp Connectors onto the chain, I like to provide the necklace with additional strength by applying a drop of glue into the Crimp Connector prior to inserting the Faceted Bead Chain. Squeeze a wee bit of Bond 527 Cement (or E6000) onto a small plastic bag. Using a toothpick, insert a tiny drop of glue into the Ball Chain Crimp Connector. While the glue is still wet, insert a single faceted bead from one of the ends of 15" Faceted Bead Chain. Repeat for the other end.

STEP 10:

Once your Faceted Bead Chain is inserted into the Ball Chain Crimp Connector, use your other pair of needle nose pliers to crimp the connector closed.

STEP 11: (Image 17)

Using your needle nose pliers, open one of the Jumping 6mm Textured Circle. Thread the jumpring through the loop on the Ball Chain Crimp Connector and Lobster Clasp 15mm. Close the jumpring. Open another Jumping 6mm Textured Circle and attach to Ball Chain Crimp Connector on the other end of the Faceted Ball Chain.

CREATING THE CHARM FOCAL

STEP 12: (Images 18-19)

Attach the remaining jumprings onto the Charm Itsy Circle, Itsy Bottle, Hammered Flat Tag and Charm Tree of Life. Open the Jumping Grande Rope and attach the Deerskin Lace, all the charms and the Faceted Bead Chain. Close the Jumping Grande Rope.

Adorn and get ready for requests from your family and friends to have you make them one!