

How To Texturize Resin with Clay Squishers

Designer: Becky Nunn

SUPPLIES NEEDED:

Nunn Design Resin Kit
 Clay Squisher
 Contemporary Jewelry Findings
 22 Gauge Wire
 Castin' Craft Opaque Pigment-Blue

OTHER:

Wet-wipes
 Baby Powder
 Ziplock Bag

TOOLS NEEDED:

Scissors
 1.8mm Hole Punch
 Flush Cutters
 Needle Nose Pliers

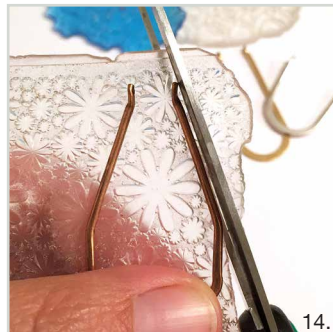
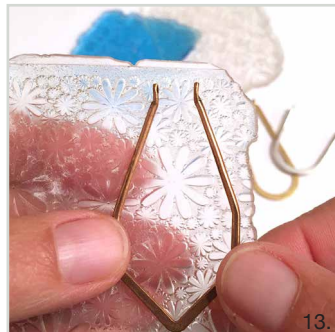
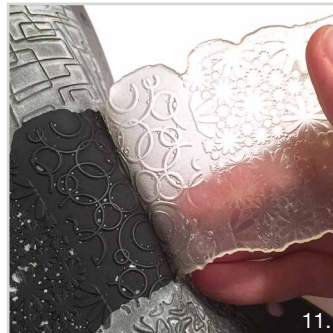
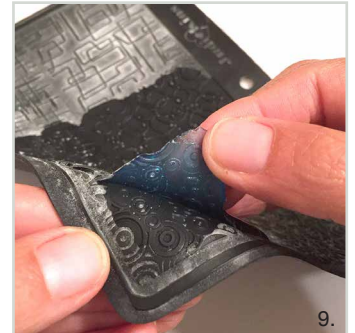
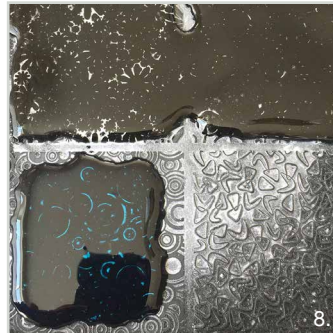
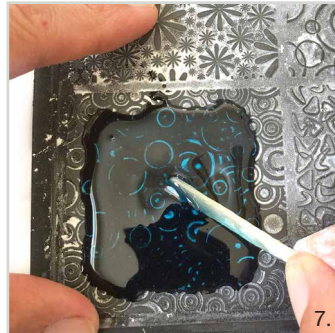
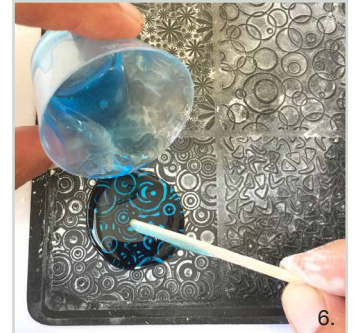

How To Texturize Resin with Clay Squishers

Designer: Becky Nunn

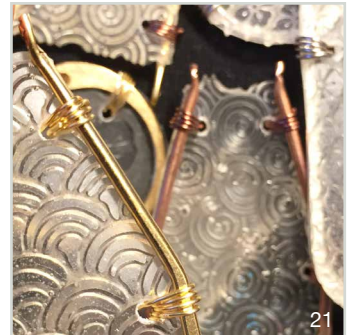

STEP 1:

Select a Clay Squisher that you would like to work with.

STEP 2: (image 2)

Pour some baby powder onto a ziplock bag. Place your fingers into the baby powder and smear it thoroughly onto the surface of the Clay Squisher.

STEP 3: (image 3)

Place the Clay Squisher pad on its side and tap it lightly onto the table. The excess baby powder will fall onto the table. Wipe down your work surface, removing any excess baby powder.

STEP 4:

Read the resin instructions for safety concerns regarding the Nunn Design Resin.

When I work with resin, I always:

- Place a large plastic bag over my work surface and tape it down.
- I make sure I have ventilation in my workroom.
- I wear gloves.
- I wear glasses (readers because I can't see anymore. Plus it protects my eyes!).
- I have a pile of wet wipes handy.

This is a great blog post that covers **20 Habits for Successfully Using Nunn Design 2-Part Epoxy Resin**. Even if you are a seasoned resin mixer, this might be worth a read.

STEP 5: (image 3)

Place one cup (included in the Nunn Design Resin Kit) onto your table. For curing purposes, it is very important that the resin be an exact 1 to 1 ratio of Part A and Part B. I suggest getting your eyes level with the resin so you can see the lines on the measuring cup. Pour Part A of your resin kit up to the ½ fluid ounce mark on

How To Texturize Resin with Clay Squishers

Designer: Becky Nunn



your measuring cup. Pour Part B of your resin kit into the same cup until it is filled to the 1 fluid ounce mark. It is important to pour Part A first and then Part B. It is some chemical thing about the part A being heavier or something.

STEP 6:

Set your timer for 2 minutes. Using the stir stick from your kit (a popsicle stick or coffee stir stick will work great too), slowly and carefully stir your resin scraping the sides as you stir. Stir for the full 2 minutes. After 2 minutes, scrape both sides of your stir stick on the edge of your resin filled cup.

STEP 7: (image 4)

To add a tint of blue to the resin, add a tiny toothpick of the Castin' Craft Opaque Pigment Blue to the mixed resin. The opaque blue pigment is very potent, so you will only need a tiny bit to colorize the fully mixed batch of resin. It is always best to add too little pigment and to add more if needed.

STEP 8: (image 5)

Alright, if you read our Texturized Resin Part 1 blog post tutorial, this is where I think I messed up. I didn't let the resin set until it was super thick before I poured it onto the Clay Squisher. With Part 1, I poured freshly mixed resin onto the Clay Squisher and I think it chemically absorbed into the rubber.

This is what it looked like when I went to peel it up! Yuck-o! (image 5)

STEP 9: (images 6-8)

In order for the resin to peel away easily once it is in the soft cured state, the resin needs to be getting good and thick before pouring it onto the Clay Squisher Texturizing Pad. Scrape out all of your remaining, thick, colored resin onto the powder-covered Clay Squisher. Spread the resin around with a stir-stick until the resin is even in height. I had some clear resin left over from another project, so I added that to another pattern on the Clay Squisher.

STEP 10:

Let resin cure for 6 hours or until the resin is hard to the touch and not sticky. This stage of the curing resin is referred to as the "soft cure" stage.

STEP 11: (images 9-12)

Let the resin cure for about 6 hours. It will be fairly firm and not tacky to the touch. Bend one of the edges of the Clay Squisher and start to pick at the edge of the resin. It might be hard to get it started, but once you do, it will be fairly easy to pull back the soft cured resin.

STEP 12: (image 13-16)

The soft cured resin will be really easy to cut with a pair of scissors. Resin must be cut and punched during the soft cure phase. It will continue to cure and hardened over the next 48 hours.

Lay a Contemporary Jewelry Finding onto the surface of the soft cured resin. Hold the Contemporary Findings and the resin in place with one hand while you cut the resin with your other.

How To Texturize Resin with Clay Squishers

Designer: Becky Nunn



STEP 13: (images 17-20)

Next, use a 1.8mm Hole Punch to create some holes in the resin. You will want to punch the holes far enough in from the edge as not to easily tear the resin when you are stitching on the 22-gauge wire.

STEP 14: (image 21)

Using a pair of flush cutters, cut 1' of 22-gauge wire. Thread the wire through the punched hole in the resin and wrap it around the Contemporary Frame several times.

STEP 15:

Use your flush cutters again to cut away the extra wire. I cut the wire consistently where it was coming up through the resin hole. Continue until all of the Contemporary Frame is secured to the texturized resin.

SHOP THE SUPPLIES!

- Nunn Design Resin Kit
- Castin' Craft Opaque Pigment-Blue
- Clay Squisher
- Contemporary Jewelry Findings