



NUNN DESIGN®

How to Make These Pantone Colors with Castin' Crafts
Opaque Pigments and Nunn Design 2-Part Resin



We look forward to bringing you exclusive innovations
and distinctive products this year and beyond.

www.nunndesign.com

How to Make These Pantone Colors with Castin' Crafts Opaque Pigments and Nunn Design 2-Part Resin

SUPPLIES NEEDED:

- Nunn Design 2-Part Resin Kit
- Resin Mixing Cups
- Resin Stir Stick Narrow
- Resin Stir Stick Wide
- Castin' Crafts Opaque Pigments

OTHER:

- Wet-wipes
- Toothpicks
- Plastic bag for work surface
- Tape
- Plastic gloves

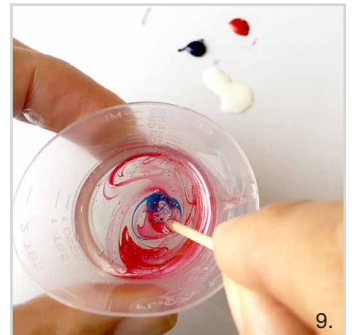
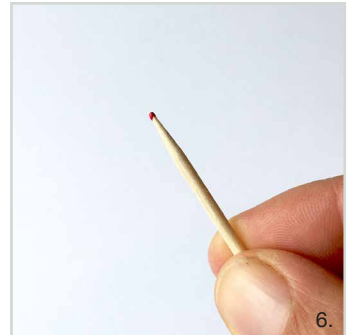
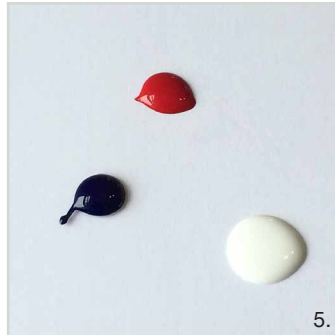

SHOP NUNN DESIGN SUPPLIES:

Nunn Design 2-Part Resin Kit
 Resin Mixing Cups
 Resin Stir Stick Narrow
 Resin Stir Stick Wide
 Castin' Crafts Opaque Pigments

OTHER:

Wet-wipes
 Toothpicks
 Plastic bag for work surface
 Tape
 Plastic gloves



STEP 1:

Read the resin instructions for safety concerns regarding the Nunn Design Resin. When I work with resin, I always:

Place a large plastic bag over my work surface and tape it down.
 I make sure I have ventilation in my workroom.
 I wear gloves.
 I wear glasses (readers because I can't see anymore. Plus it protects my eyes!).
 I have a pile of wet wipes handy.

STEP 2: (Image 1)

Place one cup (included in the Nunn Design Resin Kit) onto your table. For curing purposes, it is very important that the resin be an exact 1 to 1 ratio of Part A and Part B. I suggest getting your eyes level with the resin so you can see the lines on the measuring cup. Pour Part A of your resin kit up to the ½ fluid ounce mark on your measuring cup. Pour Part B of your resin kit into the same cup until it is filled to the 1 fluid ounce mark. It is important to pour Part A first and then Part B. It is some chemical thing about the part A being heavier or something.

STEP 3: (Image 2)

Set your timer for 2 minutes. Using the stir stick from your kit (a popsicle stick or coffee stir stick will work great too), slowly and carefully stir your resin scraping the sides as you stir. Stir for the full 2 minutes. After 2 minutes, scrape both sides of your stir stick on the edge of your resin filled cup.

STEP 4: (Images 3-4)

Once your resin is fully mixed, pour the resin into a resin mixing cup up to the 1 teaspoon line.

STEP 5: (Image 5)

Squeeze a little of the Castin' Crafts Opaque Pigments onto a plastic bag. To prevent your Castin' Crafts Opaque Pigments from being contaminated with mixed resin, you will want to use a fresh toothpick with each "toothpick tip" worth. I cut my toothpicks in half so I could easily use both ends.

STEP 6: (images 6-7)

The Castin' Craft Opaque Pigments are very potent. Let's define what a "tiny toothpick tip" and a "toothpick tip" amount of colorant should look like. This is not an exact science. If you don't get the exact amount, your color will still come out fairly close.

- A "tiny toothpick tip" should look like **image 6**.
- A "toothpick tip" should look like **image 7**.

STEP 7: (images 8-10)

Add the required amount of Castin' Crafts Opaque Pigment to the mixed resin following the formulas (**on next page**) for each of the Pantone colors. If you want to make more of any one color, double the batch!

STEP 8: (Image 11)

Once all of the Castin' Crafts Opaque Pigments are added into the resin, stir everything together with a stir stick until fully mixed.

SHOP NUNN DESIGN SUPPLIES:

Nunn Design 2-Part Resin Kit
Resin Mixing Cups
Resin Stir Stick Narrow
Resin Stir Stick Wide
Castin' Crafts Opaque Pigments

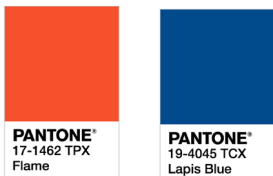

HERE ARE THE FORMULAS FOR THE 2017 SUMMER PANTONE COLORS:



PRIMROSE YELLOW

Pantone 13-0755 TPX

Formula:

1 tsp Nunn Design Resin
2 toothpick tips Yellow
1 toothpick tip White
2 toothpick tips Brown



PINK YARROW

Pantone 17-2034 TCX

Formula:

1 tsp Nunn Design Resin
2 toothpick tips Red
2 tiny toothpick tips Blue
3 toothpick tips White



PALE DOGWOOD

Pantone 13-1404 TPX

Formula:

1 tsp Nunn Design Resin
1 tiny toothpick tip Red
8 toothpick tips White
5 toothpick tips Brown



NIAGARA

Pantone 17-4123 TPX

Formula:

1 tsp Nunn Design Resin
1 toothpick tip Blue
3 toothpick tips Black
3 toothpick tips White



ISLAND PARADISE

Pantone 14-4620 TCX

Formula:

1 tsp Nunn Design Resin
1 tiny toothpick tip Blue
1 tiny toothpick tip Yellow
4 toothpick tips White



KALE

Pantone 18-0107 TCX

Formula:

1 tsp Nunn Design Resin
4 toothpick tips Yellow
1 tiny toothpick tip Blue
2 toothpick tips Black
1 toothpick tip White



FLAME

Pantone 17-1462 TPX

Formula:

1 tsp Nunn Design Resin
1 toothpick Red
2 toothpick Yellow
1 toothpick White
1 toothpick Brown



LAPIS BLUE

Pantone 19-4045 TCX

Formula:

1 tsp Nunn Design Resin
3 toothpick tips Blue
1 toothpick tip White
1 toothpick tip Black

Visit our blog post about these pantone colors:

How to Make 2017 Summer Pantone Colors with Colorized Resin

SHOP NUNN DESIGN SUPPLIES:

- Nunn Design 2-Part Resin Kit
- Resin Mixing Cups
- Resin Stir Stick Narrow
- Resin Stir Stick Wide
- Castin' Crafts Opaque Pigments



HERE ARE THE FORMULAS FOR SOME NEW PANTONE COLORS:



PINK ICING
Pantone 15-1717 TPX

Formula:
1 tsp Nunn Design Resin
2 toothpick tips White
3 tiny toothpick tips Red



SILT GREEN
Pantone 14-5706 TPX

Formula:
1 tsp Nunn Design Resin
1 tiny toothpick tip Blue
1 toothpick tip Yellow
2 toothpick tips White
2 toothpick tips Black



LILAC GRAY
Pantone 16-3905 TCX

Formula:
1 tsp Nunn Design Resin
2 toothpick tips Black
1 tiny toothpick tip Black
3 toothpick tips White
1 tiny toothpick tip Blue
1 tiny toothpick tip Red



CELERY GREEN
Pantone 13-0532 TPX

Formula:
1 tsp Nunn Design Resin
1 toothpick tip Yellow
1 very tiny toothpick tip Blue
1 toothpick tip White
1 tiny toothpick tip Brown



LAVENDER HERB
Pantone 16-3310 TPX

Formula:
1 tsp Nunn Design Resin
1 tiny toothpick tip Blue
1 toothpick tip Red
2 toothpick tips White



TANGERINE
Pantone 15-1247 TPX

Formula:
1 tsp Nunn Design Resin
1 tiny toothpick tip Red
1 toothpick tip White
2 toothpick tips Yellow



MIMOSA
Pantone 15-1247 TPX

Formula:
1 tsp Nunn Design Resin
3 toothpick tips White
3 toothpick tips Yellow
1 tiny toothpick tip Red
1 tiny toothpick tip Brown



SERENITY
Pantone 15-3919 TCX

Formula:
1 tsp Nunn Design Resin
1 toothpick tip Black
2 toothpick tips White
1 tiny toothpick tip Blue
1 tiny toothpick tip Red

Visit our blog post for more variations on these pantone colors:

New Pantone Color Formulas using Nunn Design 2-Part Epoxy Resin and Castin' Crafts Opaque Pigments

SHOP NUNN DESIGN SUPPLIES:

- Nunn Design 2-Part Resin Kit
- Resin Mixing Cups
- Resin Stir Stick Narrow
- Resin Stir Stick Wide
- Castin' Crafts Opaque Pigments

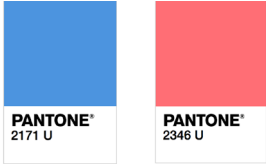

HERE ARE FORMULAS FOR SOME RETRO PANTONE COLORS:



BLUE
Pantone 2171 U

Formula:
1 tsp Nunn Design Resin
1 tiny toothpick tip Blue
2 toothpick White
1 tiny toothpick tip Yellow



EGGPLANT
Pantone 2695 CP

Formula:
1 tsp Nunn Design Resin
1 toothpick tip Blue
2 toothpick tips Red
2 Toothpick tips White



PEWTER CAST
Pantone P174-3 U

Formula:
1 tsp Nunn Design Resin
2 toothpick tips Black
2 toothpick tips White



CORAL
Pantone 2346 U

Formula:
1 tsp Nunn Design Resin
1 toothpick tip White
1.5 toothpick tips Yellow
3 tiny toothpick tips Red



Visit our blog post for more variations on these pantone colors:
6 Retro Color Formulas for Colorizing ND Resin