

USING EXCESS CRYSTAL CLAY BITS –
CREATE A BEAD!



1

To mix Crystal Clay, pinch off equal sized balls of Part A and B. Blend together until there is no marbling.



2

Roll the ball into a small snake about 3/4" long.



3

Wrap the snaked Crystal Clay around the center of a tube bead.

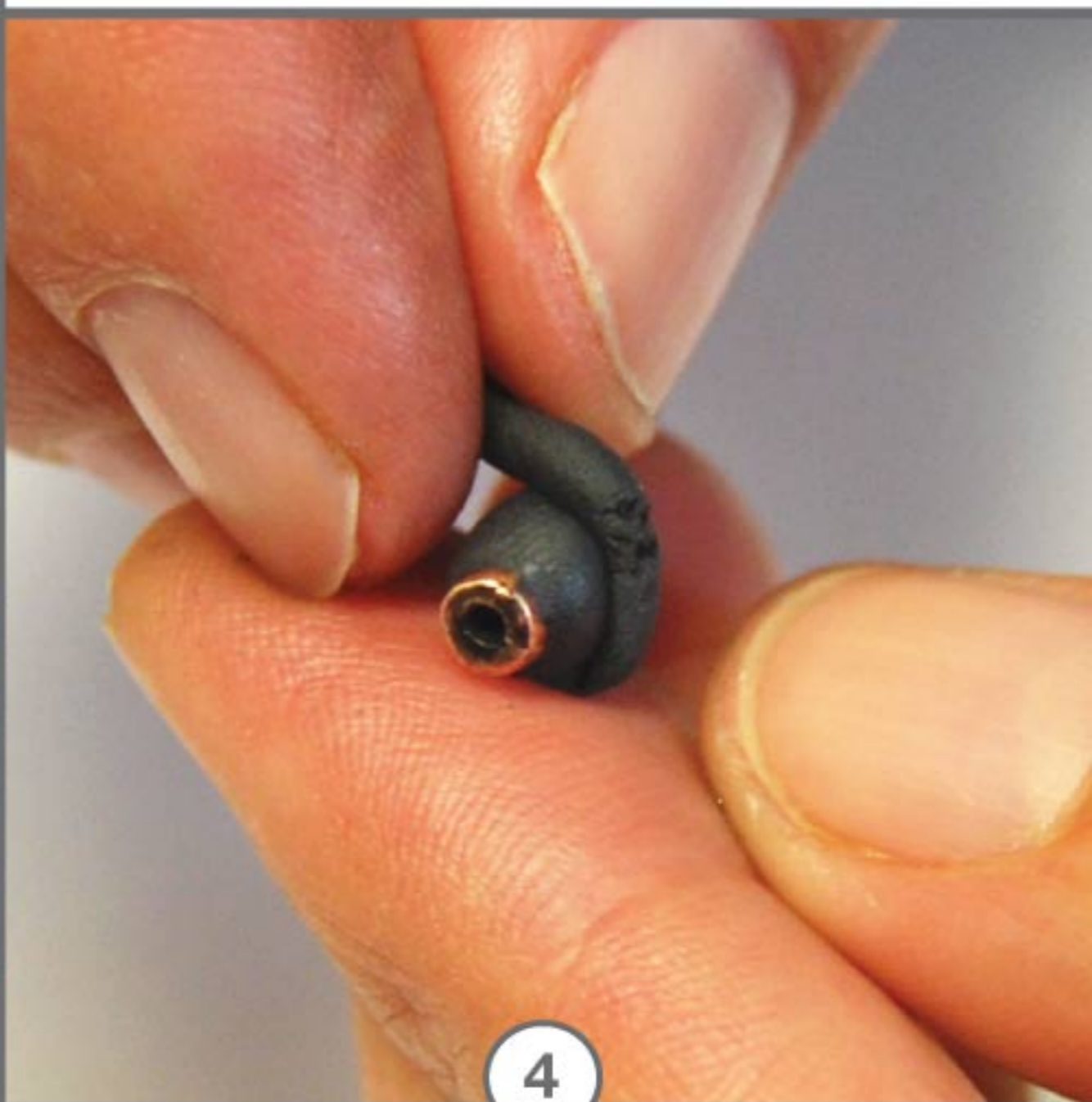

4

Add more clay if needed.

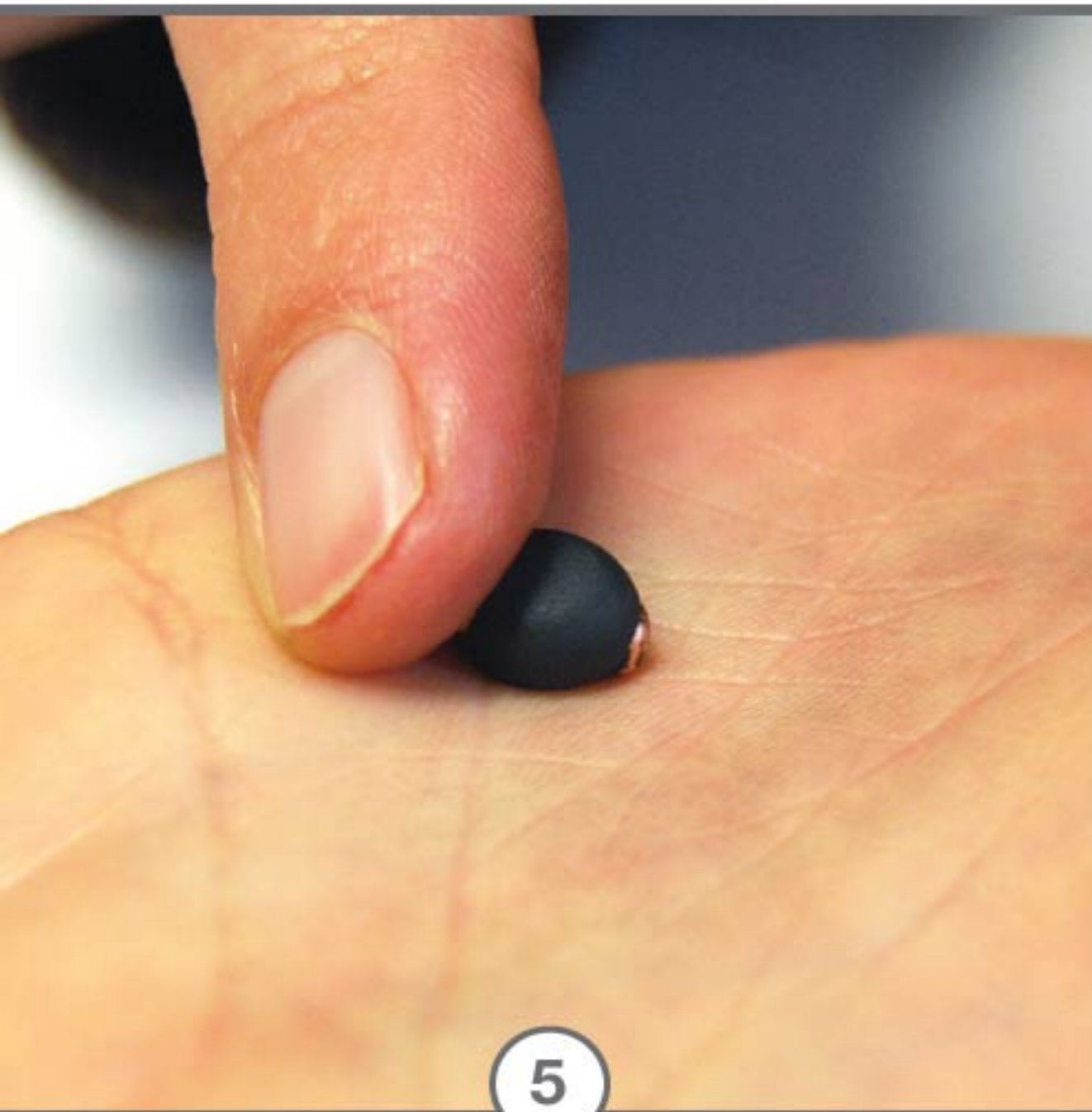

5

Roll the Crystal Clay wrapped tube bead around in the palm of your hand. As it rolls it will press to the edges of the bead.



6

Optional: Gently roll the tube bead across a texturizing pad to create a pattern in the clay. Apply baby powder to the pad beforehand.

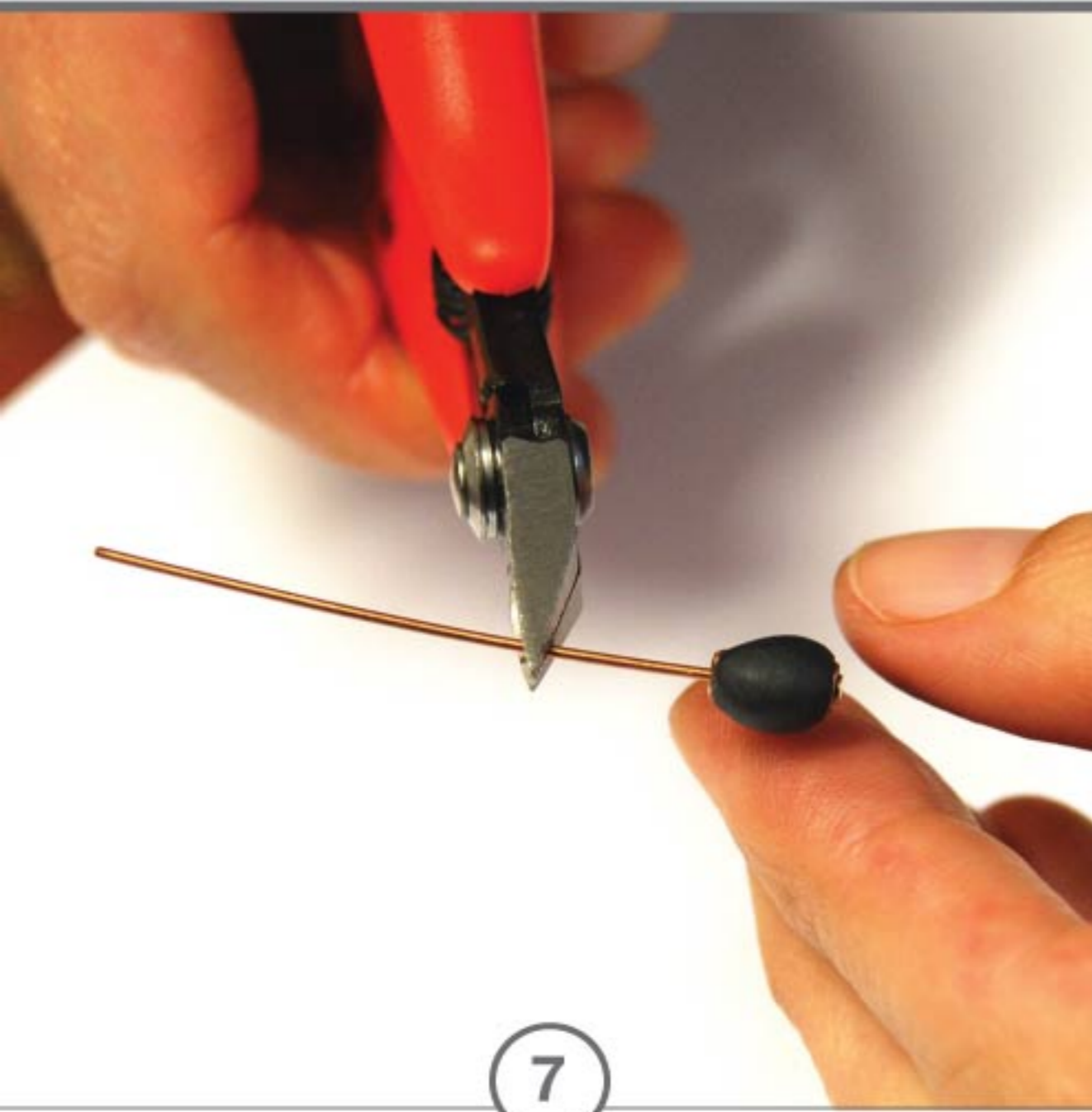

7

Once your bead has cured (12 hours), thread on a headpin. Use flush cutters to cut off the excess.

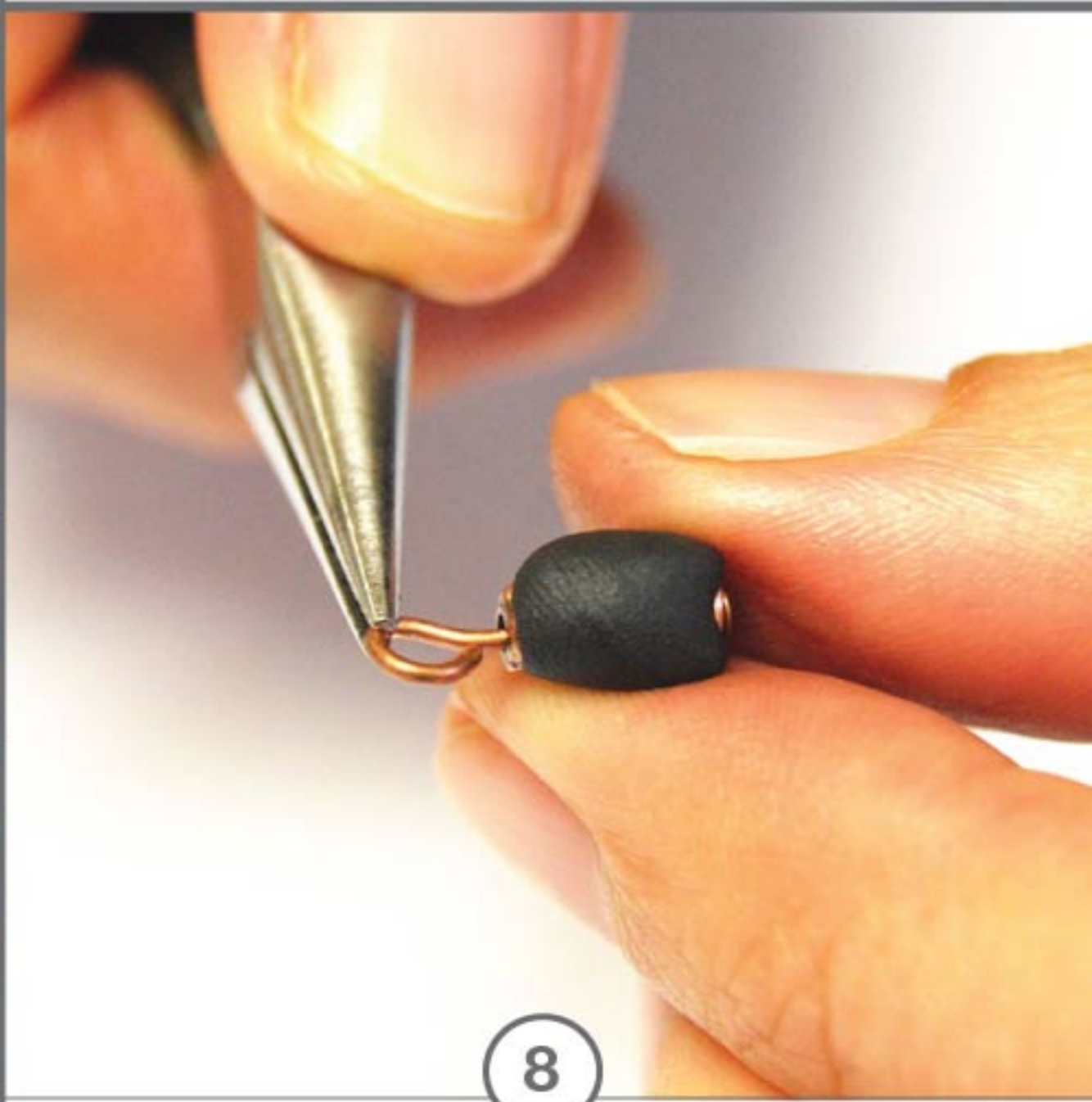

8

Create a loop with a pair of needle nose pliers. Viola. Now you are ready to assemble to your project.